



PHASER CORE
Digital Modulation Stomp Pedal
Users Manual
CORE SERIES



www.nuxefx.com

Thank you for selecting the **nux** CORE SERIES modeling stomp pedal! With many years of research we're proud to give you great guitar tones for your greatest music experience! Please take the time to read this manual carefully to get the most out of the unit. We recommend that you keep the manual at hand for future reference.

Not just a basic phaser pedal in market. Each unit has 2 types important effects that players liked.

FEATURES

- 4-stage and Tape 8-stage.
- Tone Lock function and one preset save/recall.
- New generation 32-bit DSP, high performance 24-bit 44.1kHz AD/DA convert.
- True bypass.
- Runs on batteries and AC adaptor.

Copyright

Copyright 2012 Cherub Technology Co. All rights reserved. NUX and PHASER CORE are trademarks of Cherub Technology Co. Other product names modeled in this product are trademarks of their respective companies that do not endorse and are not associated or affiliated with Cherub Technology Co.

Accuracy

Whilst every effort has been made to ensure the accuracy and content of this manual, Cherub Technology Co. makes no representations or warranties regarding the contents.

WARNING!-IMPORTANT SAFETY INSTRUCTIONS BEFORE CONNECTING, READ INSTRUCTIONS

WARNING: To reduce the risk of fire or electric shock, do not expose this appliance to rain or moisture.

CAUTION: To reduce the risk of fire or electric shock, do not remove screws. No user-serviceable parts inside. Refer servicing to qualified service personnel.

CAUTION: This equipment has been tested and found to comply with the limits for a Class B digital device pursuant to Part 15 of FCC Rules. Operation is subject to the following two conditions: (1) This device may not cause harmful interference, and (2) this device must accept any interference received, including interference that may cause undesired operation.



The lightning symbol within a triangle means "electrical caution!" It indicates the presence of information about operating voltage and potential risks of electrical shock.



The exclamation point within a triangle means "caution!" Please read the information next to all caution signs.

1. Use only the supplied power supply or power cord. If you are not sure of the type of power available, consult your dealer or local power company.
2. Do not place near heat sources, such as radiators, heat registers, or appliances which produce heat.
3. Guard against objects or liquids entering the enclosure.
4. Do not attempt to service this product yourself, as opening or removing covers may expose you to dangerous voltage points or other risks. Refer all servicing to qualified service personnel.
5. Refer all servicing to qualified service personnel.
Servicing is required when the apparatus has been damaged in any way, such as when the power supply cord or plug is damaged, liquid has been spilled or objects have fallen into the apparatus, the apparatus has been exposed to rain or moisture, does not operate normally or has been dropped.
6. The power supply cord should be unplugged when the unit is to be unused for long periods of time.
7. Protect the power cord from being walked on or pinched particularly at plugs, convenience receptacles and at the point where they exit from the apparatus.
8. Prolonged listening at high volume levels may cause irreparable hearing loss and/or damage. Always be sure to practice "safe listening".

Follow all instructions and heed all warnings
KEEP THESE INSTRUCTIONS!

PRODUCT INTERFACE

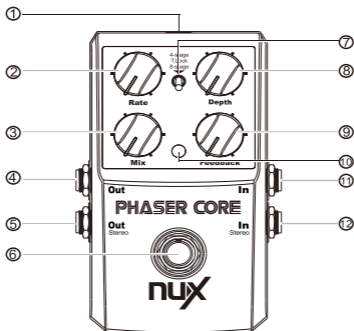

1. POWER IN

Phaser Core requires 9V DC/300 mA with center negative. Use the power supply with identical specifications.

2. Rate Knob

This knob controls the speed of phaser effect.

3. Mix Knob

Adjusts the effect level.

4. OUT Jack

Connect Phaser Core OUT to the guitar amp's input.

5. OUT STEREO Jack

Connect Phaser Core OUT STEREO to the guitar amp's input.

6. ON/OFF Switch

This footswitch is used to turn effect on/off.

7. TONE LOCK&VARIABLE toggle switch

Selecting from 4-stage to 8-stage, or freeze current setting by switching it to middle position.

8. DEPTH Knob

This knob controls the depth phaser effect.

9. Feedback Knob

This parameter controls the amount of feedback of the short modulated delay that causes the Flanging effect.

10. Indicator LED

This LED indicates the status for ON/OFF of effect.

11. INPUT Jack

Connect your guitar to Phaser Core's INPUT jack

12. INPUT STEREO Jack

If stereo signal used, connect stereo device to INPUT and INPUT STEREO jack.

INSTALLING THE BATTERIES

Battery is supplied with the unit. The life of battery may be limited, however, since their primary purpose was to enable testing.

Insert the batteries as shown in figure, being careful to orient the batteries correctly.

1. Remove the old battery from the battery housing, and remove the snap cord connected to it.
2. Connect the snap cord to the new battery, and place the battery inside the battery housing.
3. When the battery run down, the sound of unit gets distort. If this happens, replace with new battery.
4. Battery life can vary depending on battery type.
5. The power comes on when you insert the connector plug into the INPUT jack.
6. The use of an AC adaptor is recommended as the unit's power consumption is relatively high.

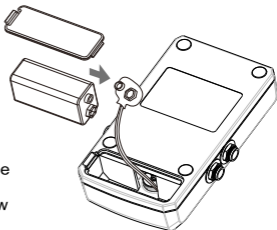

CONNECTIONS

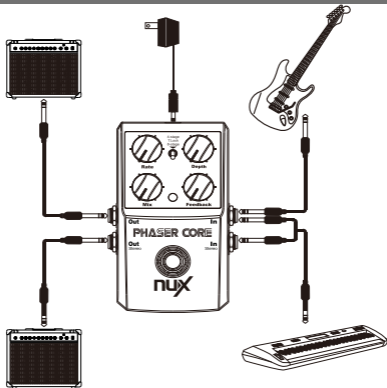

Power ON/OFF

When running the unit on battery power, inserting a plug into the INPUT will automatically switch the unit on.

To prevent malfunction and/or damage to speakers or other devices, always turn down the volume, and turn off the power on all devices before making any connections.

Once the connections have been completed, turn on power to your various device in the order specified. By turning on device in the wrong order, you risk causing malfunction and/or damage to speakers and other devices.

When powering up: Turn on the power to your guitar amp last.
When powering down: Turn off the power to your guitar amp first.

HOW TO USE TONE LOCK FUNCTION

1.Lock your setting temporarily

Switching to mid position, tone lock will lock your setting temporarily. All knobs loose its function.

2.Preset Saving/Recall function

Turn the toggle switch to T.lock after pressing and holding footswitch, you will save your preset. For recall the preset you saved, power off the pedal and then switch toggle switch to T.lock position, power on the pedal again.

3.Find you preset parameter

The current position of knobs maybe different with preset in T.lock position, you can adjust the knobs to make indicator LED flashing to find your preset parameter.

SPECIFICATIONS

- Presets:1 storable user preset
- Sampling Frequency: 44.1 kHz
- A/D converter: 24-bit
- Signal Processing:32-bit
- Frequency response:20Hz-20000Hz \pm 1dB
- THD+N:93dBu (<0.003%) A-Weighting
- Dynamic Range:100dB
- INPUT:-20dBV@1Mohm
- OUTPUT:-10dBV (Output load impedance of 10k or more)
- Power:9V DC (9V Battery, ACD-007A Adapter)
- Dimensions: 122(L) x 72(W) x 47(H)mm
- Weight:270g

PRECAUTIONS

- Environment:
 1. Do NOT use the pedal in high temperature, high humidity, or subzero environments.
 2. Do NOT use the pedal in the direct sunlight.
- Please do NOT disassemble the pedal by yourself.
- Please keep this manual for future reference.

ACCESSORIES

- Owner's manual
- 9V battery

THE FCC REGULATION WARNING (for U.S.A.)

This equipment has been tested and found to comply with the limits for a Class B digital device, pursuant to Part 15 of the FCC Rules. These limits are designed to provide reasonable protection against harmful interference in a residential installation. This equipment generates, uses, and can radiate radio frequency energy and, if not installed and used in accordance with the instructions, may cause harmful interference to radio communications. However, there is no guarantee that interference will not occur in a particular installation. If this equipment does cause harmful interference to radio or television reception, which can be determined by turning the equipment off and on, the user is encouraged to try to correct the interference by one or more of the following measures:

- Reorient or relocate the receiving antenna.
- Increase the separation between the equipment and receiver.
- Connect the equipment into an outlet on a circuit different from that to which the receiver is connected.
- Consult the dealer or an experienced radio/TV technician for help.

CE mark for European Harmonized Standards

CE Mark which is attached to our company's products of Battery mains the product is in fully conformity with the harmonized standard(s) EN 61000-6-3:2007+A1:2011 & EN 61000-6-1:2007 Under the Council Directive 2004/108/EC on Electromagnetic Compatibility.

©2012 Cherub Technology-All rights reserved.
No part of this publication may be reproduced
in any form without prior written permission
of Cherub Technology.

www.nuxefx.com



Made in China